

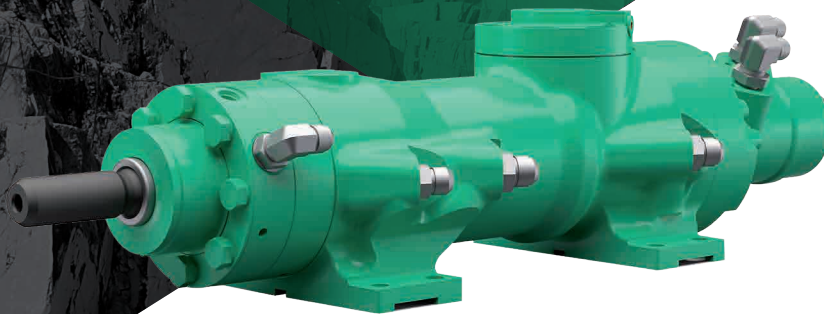

HYDRAULIC DRIFTER

HC25



POWER RATING
8 KW



FLUSHING
AIR/WATER



HOLE DIAMETER
32-51 mm

COMPACT AND POWERFUL

FOR BOTH SURFACE AND UNDERGROUND:
A VERSATILE, HIGH-PERFORMANCE
DRIFTER IN ALL ITS CONFIGURATIONS

UNDERGROUND: ROCK BOLTING AND
INSERTION OF MECHANICAL AND RESIN
BOLTS; "DRILL & BLAST" WORK

SURFACE: TUNNELING WITH HEXAGONAL
DRIFTING DRILL RODS, ANCHORING, "DRILL
& BLAST" & "DRILL & SPLIT" WORK

BENEFITS

- Single body drifter with no tie rods; reliable with **very low maintenance costs**.
- Front head of **stainless or non-stainless steel**, with an «**Air Barrier**» option for extreme bolting applications.
- Patented **inline rotation** system.
- Made in France: high quality steels, cutting-edge processes.
- Easy to install on all machines; light, with low power consumption.
- High frequency for improved performance.
- **HC25 SP:** short, non-rotating version for mechanical bolt insertion.
- **HC25 MX:** ATEX certified.



WEIGHT AND DIMENSIONS

WEIGHT (KG)

WEIGHT	72
WEIGHT	66

DIMENSIONS (MM)

A	100	
B	100	
C	83.5	
D	108.5	
E	R32M, R38M, T38M	85
F	H25F	12
	R28F, R32F	6
G	100CC MOTOR	694
	125CC MOTOR	697
	160CC MOTOR	702
H	SP VERSION	556

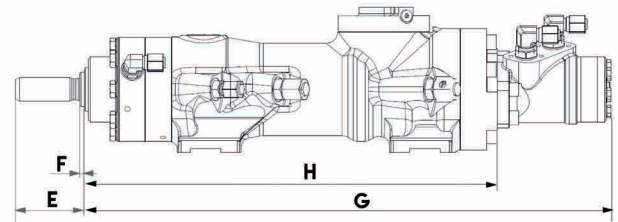
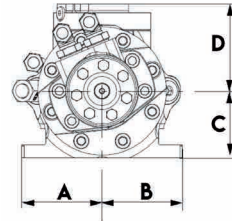

ROTATION SPECS

	100CC	125CC	160CC
ROTATION SPEED (MAX, RPM)	300	300	300
OIL FLOW (L/MIN)	30	37.5	48
PRESSURE (MAX, BAR)	210	210	210
TORQUE (MAX, NM)	301	376	482

AIR/WATER CONSUMPTION

WATER INJECTION @ 10-15 BAR (L/MIN)	20 - 50
AIR FLUSHING @ 5-10 BAR (M ³ /MIN)	4
<< AIR BARRIER >> : INTRUSION PREVENTION BY AIRBLADE	PRESSURE (BAR) 3.5-5 OIL FLOW (L/MIN) 500 - 700
FRONT END LUBRICATING AIR CONSUMPTION @ 1,5 BAR (L/MIN)	250

IMPACT RATING

POWER OUTPUT (MAX, KW)	8
PRESSURE (MAX, BAR)	150
IMPACT FREQUENCY (MAX, BPM / Hz)	3,900 / 65
IMPACT ENERGY (MAX, J)	117

OVERHAUL KITS

REFERENCE

SEAL KIT	On request
800 IMPACT HOURS KIT	On request
1600 IMPACT HOURS KIT	On request
3200 IMPACT HOURS KIT	On request

MACHINE INTEGRATION

INTELSENSE REGULATION SYSTEM	Regulates and adjusts percussive power / Seize prevention / Water safety Regulates torque and thrust
HOSES CONNECTIONS	Reversible connections (left or right) 6
SP VERSION	4
CRADLE	Can be customised on request
FEED	Timberock

SHANK ADAPTER



REFERENCE	H25F	R28F	R32F R32M	R38M	T38M
-----------	------	------	--------------	------	------

Non-exhaustive list. Please contact us for further information.



The content of this brochure constitutes non-binding information and may be changed at any time without notice. Montabert gives, and the brochure contains, no warranties whatsoever, express or implied. All the contents, including but not limited to text, images, graphics are all subject to copyright and all intellectual property protection. Their use or misuse is strictly prohibited. Montabert brand and logo used herein are the property of Montabert. Nothing contained on this document shall be construed as constituting any commitment by Montabert or as granting any license or right to use any intellectual property. ©2024 Montabert. All rights reserved.

